



FC TOPDARKNEW

for printers OKI ES7411WT/C711WT(A4) - ES9420WT/C920WT(A3) - ES9541(A3)



DESCRIPTION

Self-weeding transfer paper for colored fabrics

TECHNICAL DATA

FC TOPDARKNEW is made of 1 sheet of **FC TOPIIMAGE2** + 1 sheet of **FO TOPGLUEW4**. **FC TOPIIMAGE2** is made of a 75 g/m², 80 µm **release paper liner** and a 5 g/m², 5 µm **laser printable layer**. **FO TOPGLUEW4** is made of a 105 g/m², 120 µm **hot release liner** and a 65 g/m², 55 µm **layer of adhesive pigmented polymer**.

EQUIPMENT

White Toner Printers OKI ES7411WT/C711WT(A4) - ES9420WT/C920WT(A3) - 5 color ES9541(A3)* + heat press
* Only for the ES9541 the heat press must be set to 130°C-135°C. Time and pressure remain the same. Must set to White ON.

SUITABLE FOR

Colored cotton and other colored natural and synthetic fabrics. Ideal for t-shirts, shoppers and other fabric objects.



FEATURES

FC TOPDARKNEW is a **self-weeding, user friendly transfer paper** which **releases only toner**. It contains a white covering background layer which **boosts the colors**. Very **stretchable, soft** and with **bright colors**.

INSTRUCTIONS

1



Insert **FC TOPIIMAGE2 (A4 or A3)** from the printer's by-pass and set to extra heavy paper 1 printing mode (121-188 gr/m²). **How to recognize the printing side:** the clipped corner of the sheet must **always be on the bottom right side** in both A3 and A4 sheets. **Print in mirror mode.**

2



MATCHING

Place the new MA POLTEX pad at the centre of the plate with the blue and white side facing upwards and a sheet of anti-adhesive tissue paper (AU CFC VELIN) and heat for at least **120" at 140°C**. *This step only before the first matching!*

Place the following over the white portion of the MA POLTEX pad:

- a. FC TOPIIMAGE2 with the printed side upwards**
- b. the small paper tag (contained in the box) in the bottom right corner.** This helps to remove the FO TOPGLUEW4.
- c. FO TOPGLUEW4 (which is slightly smaller than FC TOPIIMAGE2) with the glue side on the print**
- d. a sheet of adhesive-proof tissue paper**

Then press **FO TOPGLUEW4** on **FC TOPIIMAGE2**.

Manual or air press:

140°C for 70"-90" - 4 atm/med-high pressure

3

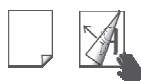

Use the small paper tag to **immediately separate (while hot) FO TOPGLUEW4 from FC TOPIIMAGE2** by holding both tissue paper and glue sheet (do not let go of the tissue paper).

New! This step is now much easier because the FC TOPIIMAGE2 will remain firmly stuck to the pad underneath.

4



Remove MA POLTEX and **place** the t-shirt or fabric on the press (heat for a couple of seconds) and then **FC TOPIIMAGE2 (after having trimmed the edges)** with the glue side on the fabric.

5



APPLICATION

Manual or air press:

140°C for 22"-25" - 4atm/med-high pressure

6



Remove FC TOPIIMAGE2 when completely cold with a smooth movement. **Press again** with adhesive-proof tissue paper for 5"-10" **for greater washing resistance.**

WARNINGS

Wash the garment inside-out at **40°C**. Do no bleach. Tumble dry at low temperature. Do not iron directly on print. For further information contact your dealer.

Store in a cool dry place.

Do not expose to direct sunlight.

If properly stored the product will maintain its features for at least 2 years.

STORAGE

The instructions on this sheet are merely indicative and contain details concerning tests carried out in our laboratories with our equipment. **It is essential to prepare the file according to the specifications of the White Toner printer.** Do your own testing. The manufacturer will replace defective material but is not responsible for any damage resulting from incorrect use.

* Available in packets containing 10 or 50 A4, 21x40 cm or A3 size FC TOPIIMAGE2 sheets + 10 or 50 20,7x29,4 cm, 20,7x39,7cm and 29,4x41,7 cm FO TOPGLUEW4 sheets. Every box contains a MA POLTEX pad, paper tags and adhesive-proof tissue paper.

SHOCKLINE
about your transfer paper

code

code